



**IMMOMARBEL**

REAL ESTATE COSTA DEL SOL

www.immomarbel.com

## San Pedro de Alcántara, Costa del Sol, Spanje

ID#: 207553



CUADRO DE SUPERFICIES

PLANTAS	SUPERFICIE UTIL	SUPERFICIE CONSTRUIDA	TERRAZAS CUBIERTAS	PATIOS Y TERRAZAS DESCUBIERTAS
PLANTA SÓTANO	179,45 m <sup>2</sup>	114,70 m <sup>2</sup>	---	---
PLANTA BAJA	35,60 m <sup>2</sup>	46,30 m <sup>2</sup>	51,40 m <sup>2</sup>	14,95 m <sup>2</sup>
PLANTA PRIMERA	57,75 m <sup>2</sup>	73,85 m <sup>2</sup>	10,20 m <sup>2</sup>	6,00 m <sup>2</sup>
TOTAL	272,80 m <sup>2</sup>	234,85 m <sup>2</sup>	61,60 m <sup>2</sup>	20,95 m <sup>2</sup>
TOTAL SOBRE BASANTE	93,35 m <sup>2</sup>	120,15 m <sup>2</sup>	61,60 m <sup>2</sup>	20,95 m <sup>2</sup>
SUP. COMPUTABLE	---	120,15 m <sup>2</sup>	---	---
TOTAL COMPUTABLE		120,15 m <sup>2</sup>		
PISCINA				4,60 m <sup>2</sup>

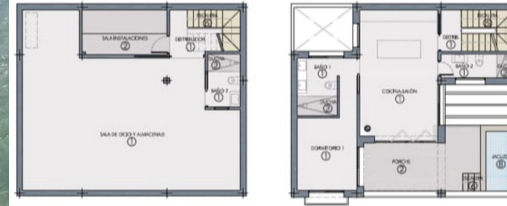

### Beschrijving:

OPPORTUNITY, Plot in an exceptional situation. The plot is qualified as buildable, the construction of the following is allowed: Single-family housing Multi-family housing  
Compatible uses: Commercial premises It has a building license for the construction of a single-family house and a commercial premises, the architecture project and the license are also delivered. The project can be modified or completely changed. The location is unbeatable ...

• Slaapkamers: 0 | • Badkamers: 0 | • Grond: 245 m<sup>2</sup> |

**Algemeen:** Dicht bij winkels, Staat uitstekend, Urbanisatie

**€440,000**

•immomarbel.com •Phone: 34.609.708.906